

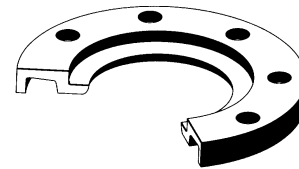

D (mm)	DN (inch)	d	a	E (mm)	S	f	n°	r	Peso Weight (kg)	
63	50	2"	78	121	164	18	19	4	4	.800
90	80	3"	108	153	196	19	19	4	4	1.000
110	100	4"	128	191	237	25	19	8	4	1.800
160	150	6"	178	241.5	297	30	22	8	4	2.000
180 <sup>1</sup>	150	6"	188	240	297	27	22	8	4	1.900
225	200	8"	238	299	354	34	22	8	4	5.100
250	250	10"	288	362	425	38	26	12	4	6.400
315	300	12"	338	432	497	51	26	12	6	12.800

### FLANGE LIBERE PPG/Fe ANSI per COLLARI PP e PE T/T - Cod. FLPPGFEA

- Profilate, con rivestimento in PP caricato vetro (30%) e inserto in ghisa sferoidale – colore nero
  - Per collari in PP cod. CART
  - Foratura secondo ANSI B16.5 CL. 150
- BACKING RINGS PPG/Fe ANSI for  
PP & PE BW STUBS - Code FLPPGFEA**
- Profiled, in PP fiber-glass (30%) reinforced and ductil iron insert – black colour
  - For PP stubs code CART
  - Drilled according to ANSI B16.5 CL. 150

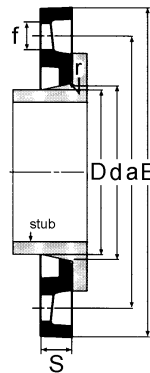

<sup>1</sup> Con foratura ISO DIN 2501 PN10 che approssima 6" ANSI CL. 150.  
Drilled according to ISO DIN 2501 PN10 that approximates 6" ANSI CL. 150.

D	DN	d	E (mm)	a	f	n°
63	50	51	157	125	18	4
75	65	61	177	145	18	4
90	80	73	192	160	18	8
110	100	90	212	180	18	8
125	100	102	242	180	18	8
140	125	114	242	210	18	8
160	150	131	278	240	22	8
180	150	147	308	240	22	8
200	200	163	333	295	22	8
225	225	184	333	295	22	8
250	250	204	390	350	22	12
280	250	229	390	350	22	12
315	300	257	440	400	22	12
355	350	290	500	460	22	16
400	400	327	555	515	25	16
450	450	368	610	565	25	20

### GUARNIZIONI EPDM – Cod. GEPDMBW

- Per collari rigati PP Testa/Testa – cod. CART
- Foratura ISO DIN 2501 PN10 (passaggio tiranti)
- EPDM colore nero - serie industria
- Spessore 2 mm
- Durezza Shore 65~70

### GASKETS EPDM – Code GEPDMBW

- For serrated PP Butt Welding Stubs - code CART
- Drilled ISO DIN 2501 PN10 (bolts' passage)
- EPDM black colour - industrial series
- Thickness 2 mm
- Hardness Shore 65~70

