



D	E	L	Z	Peso Weight (kg)	Mod.
		(mm)			
20	29.5	14.5	25	.010	a
25	35	18.5	28	.015	a
32	43	18.5	30	.025	a
40	49	22	10	.035	b
50	63	25	11	.040	b
63	75	29	11	.080	b
75	94	43	10	.175	b
90	110	38	15	.215	b
110	130	43	12	.285	b

CALOTTE - Cod. PPFCALO

- Estremità per polifusione nel bicchiere
- Dimensioni secondo serie metrica ISO 161-1

CAPS - Code PPFCALO

- Jointing by socket fusion welding in the socket
- Dimensions to suit metric series ISO 161-1

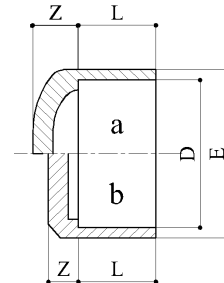

D	L	Z	l	Peso Weight (kg)
		(mm)		
20	14.5	22.5	51.5	.070
25	16	25	57	.085
32	18	25	61	.115
40	20	29	69	.175
50	23	31	77	.200
63	27	31	85	.300

BOCCHETTONI - Cod. PPFBCH

- Estremità per polifusione nel bicchiere
- Dimensioni secondo serie metrica ISO 161-1

SOCKETS UNIONS - Code PPFBCH

- Jointing by socket fusion welding in the socket
- Dimensions to suit metric series ISO 161-1

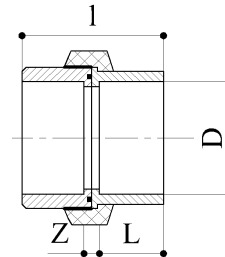

D	D1	E1	L	L1	Z	Peso Weight (kg)
			(mm)			
25	20	30	19.5	17	23.5	.015
32	20	30	22	15	34	.020
32	25	35.5	25.5	16	32	.020
40	25	36	24	19	36	.035
40	32	45	25	18.5	35	.035
50	32	45	28	21	39	.050
50	40	55	27.5	23.5	34.5	.055
63	32	41	30	23	47	.065
63	40	50	30	21	46	.065
63	50	61	36	25	40	.075
75	50	61	48	25	54	.090
75	63	75	48	29	51	.095
90	40	50	51	26	71	.135
90	50	60	35	25	58	.140
90	63	76	43	30	67	.160
90	75	90	66	33	75	.220
110	50	61	44	25	68	.230
110	63	77	43	30	70	.245
110	75	90	48	33	71	.275
110	90	109	48	37	74	.310

RIDUZIONI - Cod. PPFR

- Estremità per polifusione nel bicchiere
- Dimensioni secondo serie metrica ISO 161-1

REDUCERS - Code PPFR

- Jointing by socket fusion welding in the socket
- Dimensions to suit metric series ISO 161-1

